

Lot 64				
Tree	Diameter	Type	Health	Must Save (visual mitigation)
168	11	BLUE	16%	
169	12	BLUE	16%	
170	8	BLUE	44%	
171	11	BLUE	56%	
172	13	BLUE	56%	
173	13	BLUE	48%	
174	16	BLUE	48%	
175	14	BLUE	52%	
176	16	BLUE	52%	
177	6	BLUE	16%	
224	19	BLUE	60%	X
225	12	BLUE	44%	X
226	11	BLUE	48%	X
227	22	BLUE	68%	
228	8	BLUE	20%	
229	7	BLUE	32%	
230	14	BLUE	48%	
231	8	BLUE	32%	
232	8	BLUE	36%	
233	7	BLUE	28%	
234	12	BLUE	64%	
235	9	BLUE	48%	
236	10	BLUE	32%	
237	9	BLUE	32%	
238	19	BLUE	68%	
239	16	BLUE	60%	
240	14	BLUE	56%	
241	12	BLUE	44%	
242	16	BLUE	56%	
243	10	BLUE	32%	
244	11	BLUE	36%	
245	11	BLUE	40%	
246	14	BLUE	52%	
247	15	BLUE	44%	
248	7	BLUE	20%	
249	12	BLUE	48%	
250	20	BLUE	56%	
251	13	BLUE	44%	X
252	12	BLUE	32%	X
253	25	COAST	56%	
254	30	COAST	28%	
255	15	BLUE	40%	

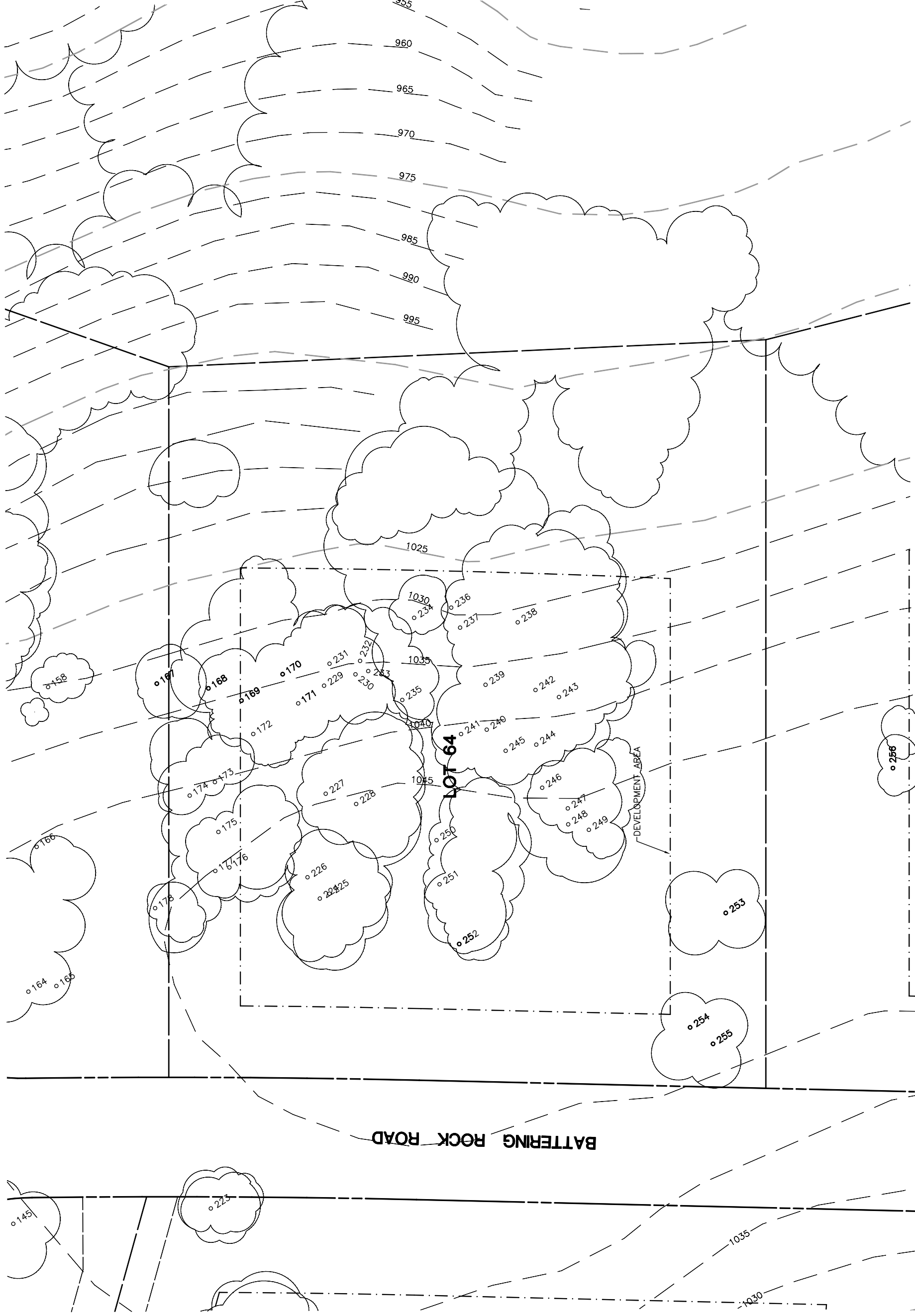

INDIVIDUAL SITE PLANS
 SANTA YSABEL RANCH
 COAL 99-0229
 LOT 64

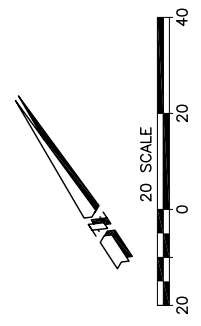

REV.	BY	DATE	DESCRIPTION

NOTE:
 ALL TREE LOCATIONS WITHIN
 BUILDING ENVELOPE TO BE
 VERIFIED PRIOR TO PERMITTING

NOTE:
 ALL TREES OUTSIDE OF BUILDING ENVELOPE
 TO BE PROTECTED. TREES MAY BE REMOVED
 BY PERMIT IF NECESSARY FOR DRIVEWAY
 ACCESS BUT REMOVAL WILL BE MINIMIZED.

NOTE:
 TREE DATA BASED ON OAK TREE
 ASSESSMENT BY JACK BRAZEL ON 10.24.00.

PLT'D: 7/26/02